

# B-50-B18 FIRE HYDRANT PARTS

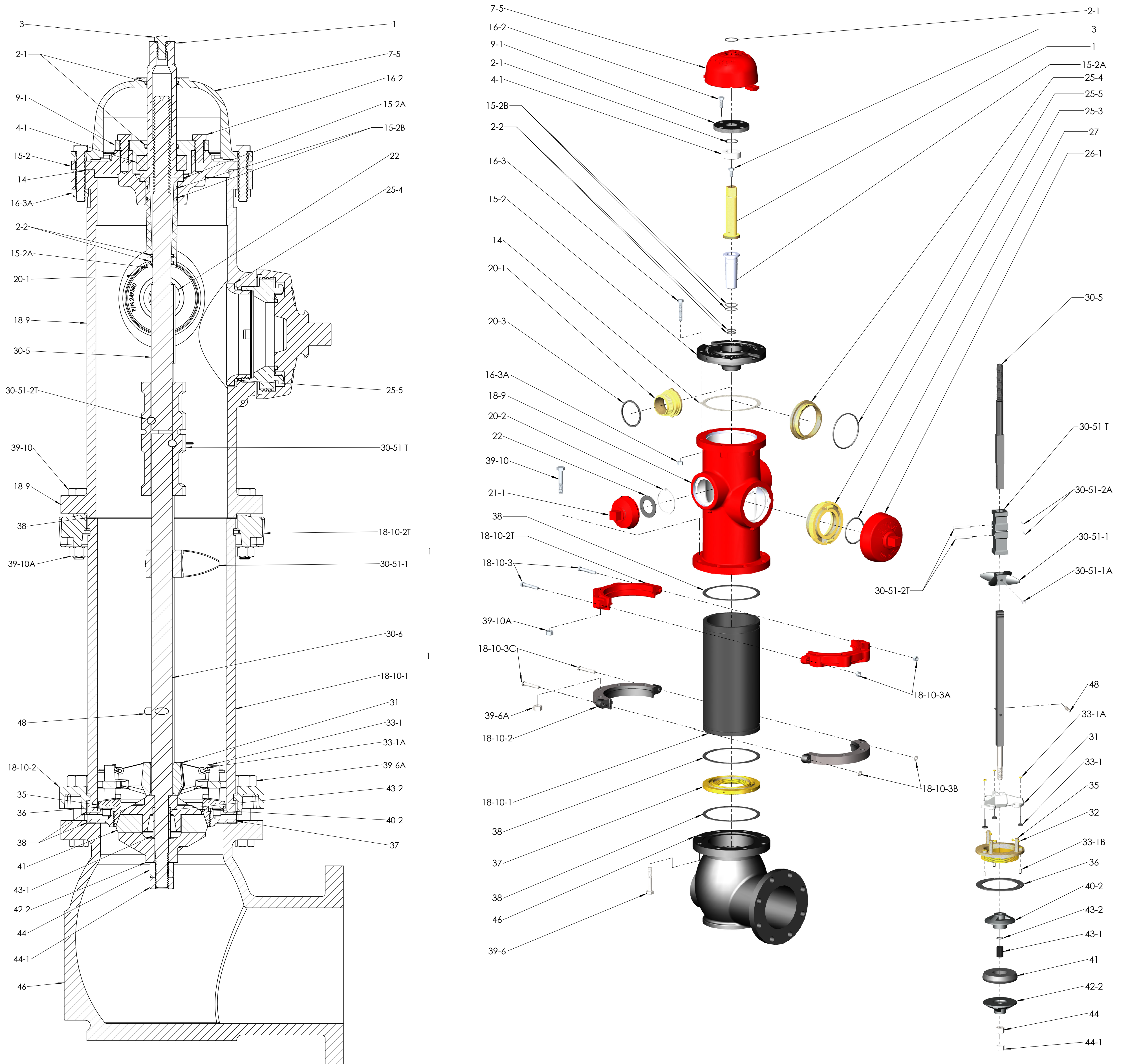

Catalog Number	Part Number	Quantity Per	Description
1	****	1	Operating nut
2-1	2000001615	2	Bonnet and housing cover O-ring
2-2	194572	2	Stem seal O-ring (#214)
3	234427	1	Lubricating screw
4-1	364378	1	Thrust bearing
7-5	191	1	Bonnet B-50-B
9-1	132	1	Bearing housing cover
14	604	1	Bearing housing gasket
15-2	372586	1	Bearing housing
15-2A	372816	1	E/M bearing housing sleeve
15-2B	373130	2	Bearing housing o-ring (#129)
16-2	45314	4	Bearing housing cap screw (short)
16-3	45373	6	Bearing housing cap screw
16-3A	45977	6	Bearing housing nut
18-9	301248	1	B50B18 upper barrel, resilient seat type
18-10-1	****	1	C.V. lower barrel
18-10-2	281301P	1	CV ductile iron hydrant barrel flange
18-10-2T	306371	1	CV split traffic flange
18-10-3	204072	2	Flange side bolt, ground line
18-10-3A	45934	2	Flange side nut, ground line
18-10-3B	281832	2	304SS flange side nut, below ground

Catalog Number	Part Number	Quantity Per	Description
18-10-3C	281824	2	304SS flange side bolt, below ground
20-1	****	2	Hose nozzle
20-2	258784	2	Hose nozzle retaining ring
20-3	258792	2	Hose nozzle gasket
21-1	****	2	Hose nozzle cap
22	1805	2	Hose nozzle cap gasket
25-3	****	1	Pumper nozzle
25-4	303364	1	Pumper nozzle retainer
25-5	195956	1	Pumper nozzle O-ring (#352)
26-1	****	1	Pumper cap
27	****	1	Pumper cap O-ring or gasket
30-5	002402	1	Upper rod - open left
	1953	1	Upper rod - open right
30-6	****	1	Lower rod
30-51 T	282383	1	CV fire hydrant breakable rod coupling
30-51-1	218219D	1	CV hydrant rod guide
30-51-1A	47155	1	Rod guide set screw
30-51-2A	195235	2	Coupling cotter pin
30-51-2T	305456	2	Coupling clevis pin
31	558	1	Drip lever
32	47414	3	Drip lever cotter pin
33-1	574	3	Drip lever washer

Catalog Number	Part Number	Quantity Per	Description
33-1A	247774	3	Drip washer retainer / hex nut
33-1B	345	3	Hydrant seat drain tube
35	213	1	CV Ø4.50" hydrant seat
36	280	1	CV hydrant seat gasket 4.5"
37	388	1	CV Ø4.50" drain ring
38	000612	3	Barrel and base gasket
39-6	234451-1	8	304SS base flange bolt
39-6A	195048	8	304SS base flange nut
39-10	321826	8	Grade 2 ground flange bolt
39-10A	190939	8	Grade 2 ground flange nut
40-2	450	1	Valve ball type
41	515	1	CV hydrant hydrant valve
42-2	485	1	Valve ball bottom, Ø4-1/2 CV hydrant
43-1	294403	1	CV hydrant valve ball top plastic sleeve
43-2	41301	1	Valve sleeve O-ring (#210)
44	142955	1	304SS 3/4-10 hex nut
44-1	376821	1	316SS 3/4-10 hex lock nut
46	****	1	Base (flanged, MJ, or slip on)
48	200001814	1	Stop pin, type E groove, 3/8"x2"

Parts numbers marked with \*\*\*\* are to be specified by the customer.  
\*30-5-1 quantity varies with trench depth

**Mueller Canada**

Copyright © 2015 Mueller Canada. All Rights Reserved.  
The trademarks, logos and service marks displayed in this document herein are the property of Mueller Canada, its affiliates or other third parties. These products are intended for use in potable water applications. Please contact your Mueller Canada Sales or Customer Service Representative concerning any other application(s).

Form MC139 - Rev 1/15



Ref. Stelem	Description	Ref. manufacturer
1101	Operating nut	1
1103	Lubricating screw	3
1104	Operating nut allen screw	1-3
1105	Bonnet	7-4
1106	Operating nut "O" ring	1-4
1107	Lower piece (operating nut)	1-2
1108	Bonnet gasket	2-1
1109	Bonnet nut & bolt	16
1110	Ball bearing	4-1
1112	Thrust bearing housing cover	9-1
1113	Bolt for thrust bearing housing cover	16-2
1114	Thrust bearing cover "O" ring	2-1
1115-em	Bearing housing	15-2 / 15-2A
1116	Cone gasket	14
1117	Cone "O" ring	2-2
1120	Upper stem	30-5-1
1125	Hose nozzle 2 1/2"	20-1
1126	Hose nozzle gasket	20-3
1127	Hose nozzle retaining ring	20-2
1130	Hose nozzle cap (gasket included)	21
1131	Hose nozzle cap gasket	22
1135	Pumper nozzle	25-3
1136	Pumper nozzle gasket	25-5
1137	Pumper nozzle retaining ring	25-4
1140	Pumper nozzle cap	26-1
1141	Pumper nozzle cap gasket	27
1142	Retaining cable	
1145	Coupling	30-51
1146	Clevis and pin for rod coupling	30-51-2T
1147	Security coupling (iron)	30-51T
1148	Security coupling nut & bolt	
1150	Upper barrel 2H1P	18-9
1155	Safety flange	18-10-2T
1156	Flange coupling nut & bolt	18-10-3
1158	Flange nut & bolt	39-10
1159	Flange gasket	38
1160	Lower stem	30
1165	Stem guide	30-51-1
1166	Stem guide bolt	30-51-1A
1168	Stop pin	48
1169	Main valve seat 4"	35
1170	Main valve seat 5"	35
1171	Main valve seat gasket	36
1172	Drain plug	35-1
1175	Drip valve	31
1176	Drip valve ring & gasket	33-1
1177	Drip valve cotter pin	32
1178	Valve ball top	40-2
1180	Main valve disc 4.5"	41-4
1280	Main valve disc 4.5"	41-4
1185	Valve ball bottom	42-2
1186	Valve ball lead "O" ring	43-2
1187	Valve ball lead gasket	43
1188	Valve ball sleeve	43-1
1189	Rod nut	44
1190	Rod nut	44